

Gigabit PoE Injector

Model No. SP390I



Introduction

Micronet SP390I is a single port, high-power solution for remote powering of current and emerging high power applications. Generating up to 30W, SP390I enables remote power for a new range of applications including 802.11 Access Points, pan-tilt-zoom (PTZ) cameras and video-phones. It complies to IEEE 802.3at PoE standard and is backward compatible to IEEE802.3af. It can power both existing 10/100Base-T network devices and emerging wireless 1000Base-T devices such as IP camera and wireless IEEE 802.11n access points.

Key Features

- Up to 30W of Power on 2-pairs
- IEEE 802.3at Compliant with 2-event Classification
- IEEE 802.3af Backward Compatible
- Compatible With All IEEE 802.3af or Legacy
- Safe: Low Power Devices Receive Only the Power They Need
- Safe and Reliable Power to any PoE Powered Devices, i.e. WiFi AP & IP Camera
- Automatic Detection and Protection of Nonstandard Ethernet Terminals
- Supports 10/100/1000Base-T applications

Application

Related Products



SP6526
26 Gigabit Managed Switch



SP5923
IP Camera with PoE

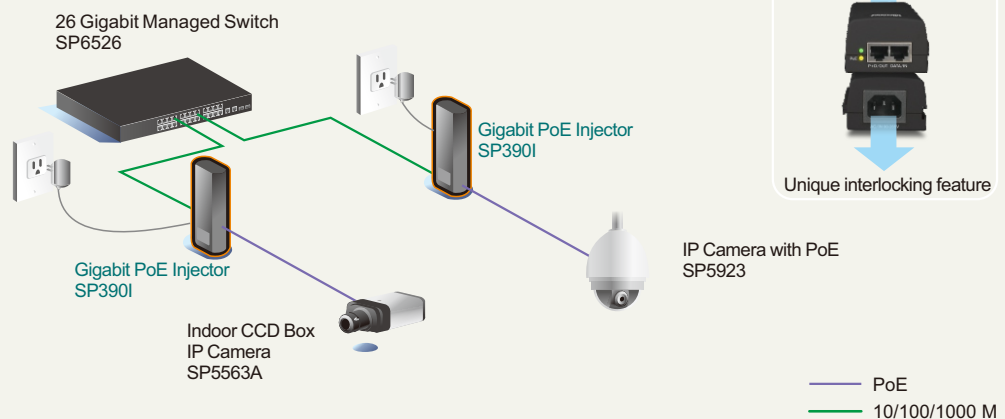

Gigabit PoE Injector

SPECIFICATION AND PRODUCT FEATURES

Model	SP390I
Standards	IEEE802.3, 10Base-T IEEE802.3u, 100Base-TX IEEE802.3ab, 1000Base-T
Interface	10/100/1000 Mbps, RJ-45 x 2 (Data In x1; Data and Power Out x 1)
Pin Assignment and Polarity	1/2 (+), 3/6(-); 4/5(+), 7/8(-)
Output Power Voltage	54Vdc
User Port Power	30 Watts
Connectors	Shielded RJ-45, EIA 568A and 568B
Input Power	100-240V, 50-60Hz
Weight	350g
Dimension	145 x 64 x 41 mm;
Temperature	Operating: -10~45°C, Storage: -20~70°C
Safety Approvals	EN 60950:2006
Regulatory	IEEE 802.3at, IEEE802.3af

The product specifications are subject to change without prior notice

ORDERING INFORMATION

Model	Description
SP390I	Gigabit PoE Injector

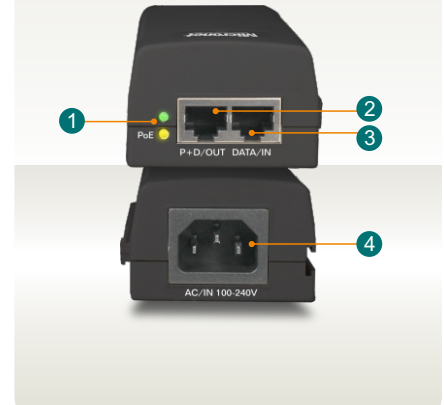

Gigabit PoE Injector

Model No. SP390I

- 1 LED Indicators
- 2 DATA/Out Port
- 3 DATA/In Port
- 4 Power Jack

COMPANION PRODUCTS

Consider the following Micronet products as a factor in your network planning.

Ethernet Switch

Industrial Ethernet

IP Surveillance

Wireless LAN

VDSL ADSL and Broadband

IP Telephony

KVM Switch

Network Appliance

Structured Cabling System

Copyright 2012 Micronet Communications Inc. All technical information in this document is subject to change without prior notice. Micronet, EtherFast and MicroView are registered trademarks of Micronet Communications Inc. All other trademarks and registered trademarks are properties of their respective holders.

Micronet Communications Inc.

E-mail: sales@micronet.com.tw; support@micronet.com.tw Web: www.micronet.com.tw

Distributor:

